

Town Property At 21 Peatfield Street



LEGEND



Town Property

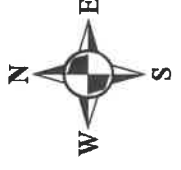

Department of Planning & Development
Open Space Program
September 2016
Town of Ipswich and MassGIS GIS data sources
Map intended for illustrative purposes only

USGS Map 21 Peatfield Street, Ipswich MA

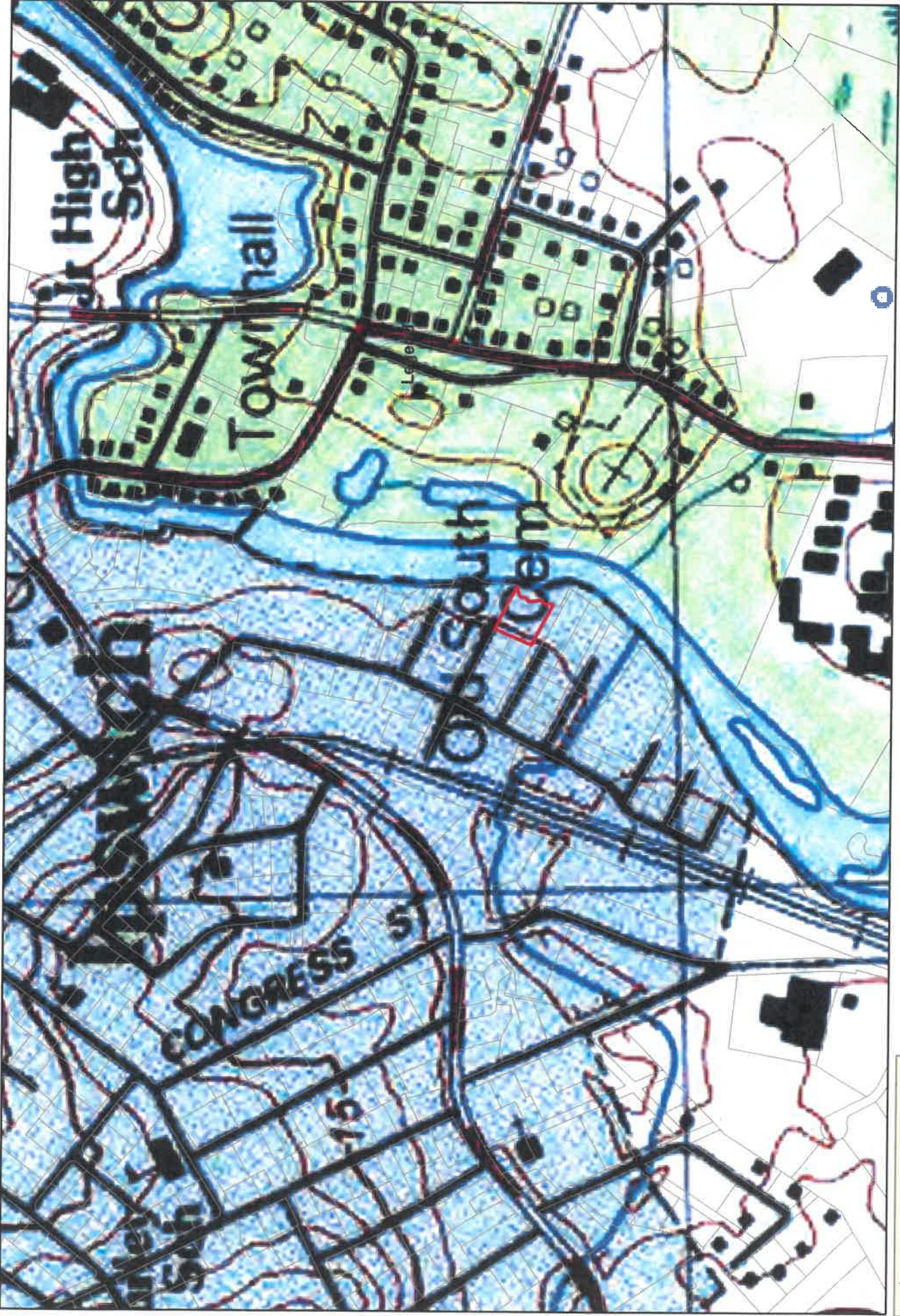

Legend

- Peatfield Landing

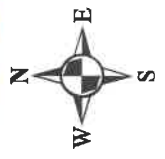

January, 2017
Department of Planning & Development
Open Space Program
Town of Ipswich and MassGIS GIS data sources
This map is for illustrative purposes only
The easements and boundary lines depicted are

TOWN OF IPSWICH
MASSACHUSETTS

REGULATIONS ON THE USE OF UNIMPROVED TOWN LANDS

Purpose: Subject to the within regulations, citizens are encouraged to visit and enjoy the use of their Town lands, many of which have excellent networks of trails. These regulations are intended to protect the natural resources and make recreation on public property enjoyable for the public.

1. No person shall camp or remain overnight on any Town land without advance written permission from the town manager or his designee.
2. No person shall possess or consume any alcoholic beverage on Town land.
3. Littering on and defacing any Town property is prohibited.
4. Harassment of wildlife and/or other people on Town lands is prohibited.
5. Cutting of timber or hay on Town lands, without advance written permission from the town manager or his designee, is prohibited. Any timber and/or hay cutting contemplated on Town lands in areas subject to the jurisdiction of the Conservation Commission shall be conditioned on obtaining of all additionally required permits from said Commission.
6. No person shall build, add to, or allow any open fire on Town land without advance written permission from the town manager or his designee, except in self-contained portable structures intended for cooking at the following locations: land under control of the Town at Crane Beach, Sandy Point, and Little Neck Causeway.
7. Other than within streets, ways, and parking lots, no unauthorized motorized vehicle shall be allowed in any Town land except within areas specifically designated therefore by the town manager or his designee.
8. No person shall hunt, trap, or discharge any firearm without written permission from the town manager or his designee. This regulation shall not apply to a law enforcement officer acting in the performance of his/her duties, nor shall it prohibit hunting on salt marshland of the Town or on other Town lands specifically designated for hunting by the Board of Selectmen. Said consent from the town manager or his designee shall be carried at all times by any person so hunting, trapping and/or shooting, and upon request shall be shown to any law enforcement officer.
9. These regulations shall be publicized and enforced with appropriate signs and barriers. They shall apply to all lands owned at the time of adoption and to those hereinafter acquired by the Town. *If any board, committee, or commission contemplates adopting any amendment to its Regulations on the Use of Unimproved Town Lands with respect to land under its care, custody and control, it shall notify in writing all other Boards, Committees and Commissions having similar Regulations prior to the hearing thereon.*

[Adopted effective 8/1/02]

TOWN OF IPSWICH
MASSACHUSETTS

USE OF TOWN LAND REGULATIONS

The following Regulations shall govern the conduct of all persons, other than police officers and other town officials while in the performance of their official duties, using any property and buildings thereon, except public ways and parking lots, owned by the Town, including all property under the jurisdiction of the Conservation Commission, Recreation and Park Committee, and the Cemetery Commission, namely parks and recreation areas, conservation land, and cemeteries, provided, however, that to the extent any of the following conflict with the "Regulations for the Use of Conservation Lands", issued by the Conservation Commission, and/or "Regulations on the Use of Unimproved Lands" adopted by the Board of Selectmen, the Conservation Commission, the Cemeteries and Parks Commission, and/or the School Committee, the latter shall prevail.

The following conduct shall be prohibited on said Town properties:

1. To cut, break, deface, damage or misuse any building, fence, structure or other real or personal property thereon.
2. Except in the following locations, to kindle a fire without a permit from the applicable Town Official(s): land under control of the Town at Crane's Beach, Sandy Point, Little Neck Causeway and Mile Lane Nature Center.
3. To post, paint, affix or display any advertising device or sign; nor to engage in business, sell, expose for sale or give away any goods or conduct fund solicitations without a written permit from the appropriate Town Official(s).
4. Willful violation of any of the above shall be punished by a fine not to exceed \$50.00 for each offense.

(Effective November 1, 1979; amended effective August 1, 2002)